

FOR LEASE

VIKTORIA PLACE
GRANDE PRAIRIE
ALBERTA



MAIN FLOOR DOWNTOWN

Details

Address: 103, 9817-101 Ave
Area: 3,915 sq ft
Net Rent: \$16.00/sq ft
CAM: \$7.92/sq ft incl. util.
Occupancy: Immediate

Features

Primary Market: 72,767
Downtown Grande Prairie
Easy access and available street front
parking for clients.
Designated parking stalls available.



Reed and Company Inc.
200, 8712 – 51 Avenue
Edmonton, AB
Phone: (780) 482-3278
www.reedco.ca

No warranty or representation, expressed or implied, is made as to the accuracy of the information contained herein, and same is submitted subject to errors, omissions, change of price, rental or other conditions, withdrawal without notice, and to any specific listing condition, imposed by our principals.

FOR LEASE

VIKTORIA PLACE GRANDE PRAIRIE ALBERTA

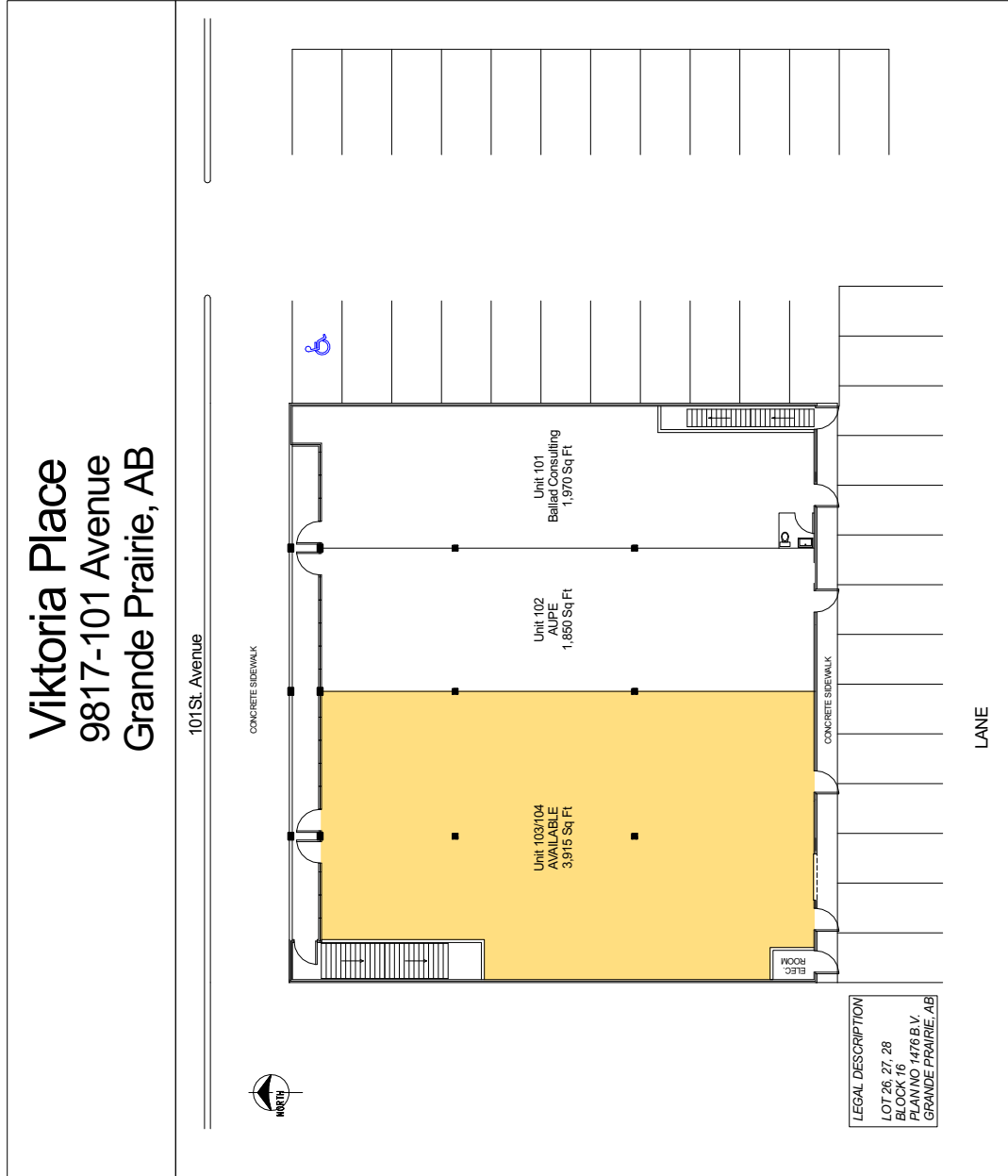

MAIN FLOOR DOWNTOWN



Reed and Company Inc.
200, 8712 – 51 Avenue
Edmonton, AB
Phone: (780) 482-3278
www.reedco.ca

FOR LEASE

VIKTORIA PLACE GRANDE PRAIRIE ALBERTA

MAIN FLOOR DOWNTOWN

| Attribute | Benchmark Alberta (PR,AB) | | Viktoria Place 10 Min DT | | |
|---|---------------------------------|---------|--------------------------|---------|-------|
| | Value | Percent | Value | Percent | Index |
| SUMMARY | | | | | |
| Total population | 4,417,880 | | 72,767 | | |
| Total population age 15 and over | 3,568,240 | | 57,401 | | |
| Total number of private households | 1,648,840 | | 26,829 | | |
| Average number of persons in private households | 2.62 | | 2.58 | | 98 |
| Total population in private households | 4,322,180 | | 71,236 | | |
| Total number of census families in private households | 1,192,910 | | 19,286 | | |
| Average number of persons per census family | 3.03 | | 3.03 | | 100 |
| Total population in families | 4,417,880 | | 56,629 | | |
| Total number of labour force age 15 and over | 2,559,960 | | 44,552 | | |
| POPULATION AGE | | | | | |
| Population age 0-14 | 849,637 | 19.23% | 15,366 | 21.12% | 110 |
| Population age 15-24 | 530,635 | 12.01% | 9,238 | 12.70% | 106 |
| Population age 25-34 | 672,998 | 15.23% | 14,264 | 19.60% | 129 |
| Population age 35-44 | 659,437 | 14.93% | 12,011 | 16.51% | 111 |
| Population age 45-54 | 594,790 | 13.46% | 8,784 | 12.07% | 90 |
| Population age 55-64 | 571,343 | 12.93% | 7,537 | 10.36% | 80 |
| Population age 65+ | 539,039 | 12.20% | 5,568 | 7.65% | 63 |
| DWELLING | | | | | |
| Total number of occupied private dwellings | 1,648,840 | | 26,829 | | |
| Average dwelling value \$ | \$552,421 | | \$351,365 | | 64 |
| Home owners | 1,194,760 | 72.46% | 17,341 | 64.64% | 89 |
| Home tenants | 443,675 | 26.91% | 9,488 | 35.36% | 131 |
| Band housing | 10,440 | 0.63% | 0 | 0.00% | 0 |
| HOUSEHOLDS | | | | | |
| One-family households | 1,123,810 | 68.16% | 17,453 | 65.05% | 95 |
| Multiple-family households | 39,095 | 2.37% | 429 | 1.60% | 68 |
| Non-family households | 485,932 | 29.47% | 8,947 | 33.35% | 113 |
| EDUCATION | | | | | |
| Total population aged 15 years and over by highest certificate, diploma or degree | 3,568,240 | | 57,401 | | |
| No certificate, diploma or degree | 600,869 | 16.84% | 11,510 | 20.05% | 119 |
| High school diploma or equivalent | 994,738 | 27.88% | 18,766 | 32.69% | 117 |
| Postsecondary certificate, diploma or degree | 1,972,630 | 55.28% | 27,125 | 47.26% | 85 |
| Apprenticeship or trades certificate or diploma | 343,998 | 9.64% | 6,272 | 10.93% | 113 |
| College, CEGEP or other non-university certificate or diploma | 682,150 | 19.12% | 11,492 | 20.02% | 105 |
| University certificate or diploma below bachelor level | 109,813 | 3.08% | 1,426 | 2.48% | 81 |
| University certificate, diploma or degree at bachelor level or above | 836,673 | 23.45% | 7,935 | 13.82% | 59 |
| Bachelor degree | 584,264 | 16.37% | 5,899 | 10.28% | 63 |
| INCOME | | | | | |
| Average family income \$ | \$161,149 | | \$150,874 | | 94 |
| Average household income \$ | \$138,393 | | \$134,670 | | 97 |



Reed and Company Inc.
200, 8712 – 51 Avenue
Edmonton, AB
Phone: (780) 482-3278
www.reedco.ca