

LION PLAZA FOR LEASE



RED DEER RETAIL

Details

Up to 11,587 sq ft contiguous
Net Rent: market
CAM/Taxes: \$6.50/sq ft

Features

Primary Market: 24,945
Market dominated by young families.
Excellent exposure to Gaetz Avenue.
Red Deer remains one of Alberta's most
stable and successful markets.



Reed and Company Inc.
200, 8712 – 51 Avenue
Edmonton, AB
Phone: (780) 482-3278
E-mail: joe@reedco.ca

No warranty or representation, expressed or implied, is made as to the accuracy of the information contained herein, and same is submitted subject to errors, omissions, change of price, rental or other conditions, withdrawal without notice, and to any specific listing condition, imposed by our principals.

LION PLAZA FOR LEASE



RED DEER RETAIL



Reed and Company Inc.
200, 8712 – 51 Avenue
Edmonton, AB
Phone: (780) 482-3278
E-mail: joe@reedco.ca

LION PLAZA FOR LEASE

Lion Plaza Red Deer, AB

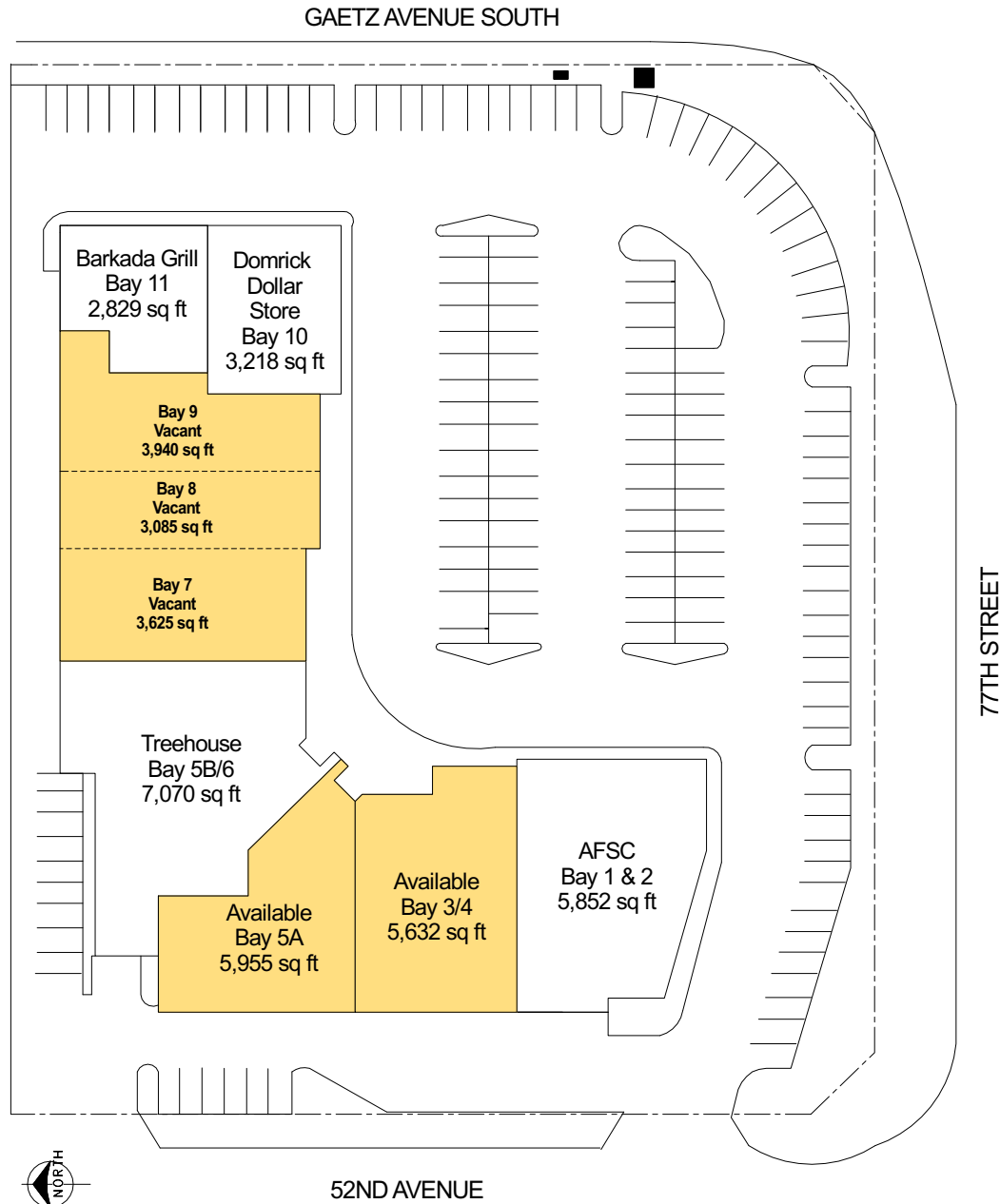

RED DEER RETAIL



Reed and Company Inc.
200, 8712 – 51 Avenue
Edmonton, AB
Phone: (780) 482-3278
E-mail: joe@reedco.ca

LION PLAZA FOR LEASE

Attribute	Benchmark Red Deer (CMA/CA,AB)		Lion Plaza 5 Minute Drive Time		
	Value	Percent	Value	Percent	Index
SUMMARY					
Total population	108,833		24,945		
Total population age 15 and over	88,567		20,055		
Total number of private households	43,197		9,623		
Average number of persons in private households	2.47		2.51		102
Total population in private households	106,641		24,636		
Total number of census families in private households	29,184		6,722		
Average number of persons per census family	2.94		2.90		99
Total population in families	108,833		19,096		
Total number of labour force age 15 and over	64,824		14,542		
POPULATION AGE					
Population age 0-14	20,267	18.62%	4,890	19.60%	105
Population age 15-24	13,504	12.41%	3,129	12.55%	101
Population age 25-34	17,512	16.09%	4,342	17.41%	108
Population age 35-44	16,352	15.02%	3,852	15.44%	103
Population age 45-54	14,054	12.91%	3,096	12.41%	96
Population age 55-64	14,080	12.94%	3,137	12.58%	97
Population age 65+	13,064	12.00%	2,498	10.02%	84
DWELLING					
Total number of occupied private dwellings	43,197		9,623		
Average dwelling value \$	\$421,715		\$312,289		74
Home owners	28,498	65.97%	5,821	60.49%	92
Home tenants	14,698	34.03%	3,802	39.51%	116
Band housing	0	0.00%	0	0.00%	
HOUSEHOLDS					
One-family households	27,870	64.52%	6,000	62.35%	97
Multiple-family households	776	1.80%	160	1.67%	93
Non-family households	14,551	33.69%	3,463	35.98%	107
EDUCATION					
Total population aged 15 years and over by highest certificate, diploma or degree	88,567		20,055		
No certificate, diploma or degree	15,607	17.62%	4,417	22.03%	125
High school diploma or equivalent	27,658	31.23%	6,675	33.28%	107
Postsecondary certificate, diploma or degree	45,302	51.15%	8,963	44.69%	87
Apprenticeship or trades certificate or diploma	9,953	11.24%	2,468	12.31%	110
College, CEGEP or other non-university certificate or diploma	18,310	20.67%	3,871	19.30%	93
University certificate or diploma below bachelor level	2,405	2.72%	457	2.28%	84
University certificate, diploma or degree at bachelor level or above	14,634	16.52%	2,167	10.80%	65
Bachelor degree	10,690	12.07%	1,638	8.17%	68
INCOME					
Average family income \$	\$140,588		\$118,569		84
Average household income \$	\$118,423		\$103,664		88

RED DEER RETAIL



Reed and Company Inc.
200, 8712 – 51 Avenue
Edmonton, AB
Phone: (780) 482-3278
E-mail: joe@reedco.ca